

FRONT VIEW

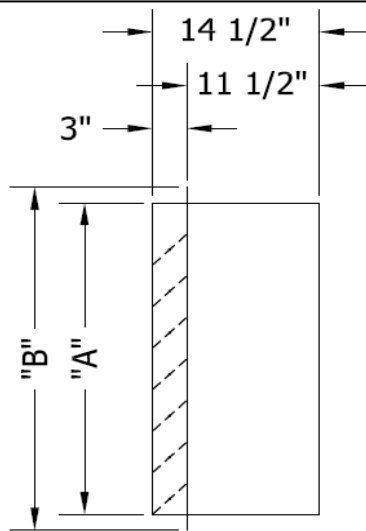

END VIEW

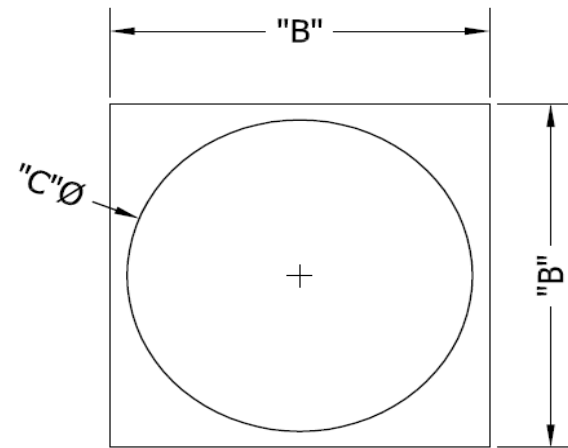

REAR VIEW

NOTE: AS16 REPLACES AS14 FOR 14"Ø DUCT.

AUTOMATIC SHUTTER			
PART #	"A"	"B"	"C"
AS16	16"	19"	14"Ø
AS18	18"	21"	18"Ø
AS24	24"	27"	24"Ø
AS30	30"	33"	30"Ø
AS34	34"	37"	34"Ø
AS36	36"	39"	36"Ø
AS42	42"	45"	42"Ø
AS48	48"	51"	48"Ø



All drawings, sketches and/or specifications accompanying or attached to these quotes are the property of Paint Booth Technologies. If the said quote(s) of Paint Booth Technologies are not accepted the said drawings, etc. shall be returned to Paint Booth Technologies. All digital data is issued for information only. You should use this data for reference purposes only to assist in coordinating your work and is supplementary to formally issued paper drawings. In all instances the contract issue drawings govern. It is the responsibility of the recipient to check all digital information against the contract documentation. Paint Booth Technologies accepts no liability or responsibility for any loss or damage suffered as a result of (or in connection with) the use or misuse of the CAD data supplied for information only. Once the data is introduced into your own CAD or other system, Paint Booth Technologies can take no responsibility for its accuracy.

FILE NAME: C:\es\in manual\standard parts\auto shutter.dwg		DRAWN BY: [REDACTED]	
JOB NO: [REDACTED]		DISTRIBUTION:	
DRAWN BY: PAUL WELCH		CUSTOMER APPROVAL:	
DATE: 9/26/2006		DISTRIBUTOR:	
PLOT DATE: 9/26/2006		END USER:	
CHECK DATE:		CUSTOMER APPROVAL:	
ORDER DATE:		SCALE: NTS	
CIC:		SHEET: 1 OF 1	
DATE: CUSTOMER PACE		DWG FILE: AUTO SHUTTER.DWG	
B -		REVISION:	

STANDARD PARTS/AUTO SHUTT